

Thank you for choosing the award winning Manrose Genius - the leading 100mm intelligent through wall ventilation fan kit. This innovative ventilation product was designed and built in Sweden by a sister company in our group - PAX. The PAX User and Installation Guide, included in the Manrose Genius Kit, is applicable to the Manrose Genius, except for the specific details below. Locate the App by searching for *Simx Connect* from compatible android or iOS devices, using Google Play or App Store respectively.

Activate the App

Enter the fan's unique code, found on the right leg of the motor unit shown below, to activate the Simx Connect App.

To remove the motor unit, firmly grip and pull out from the housing. To return the motor unit to the housing, align tabs and click back into position.

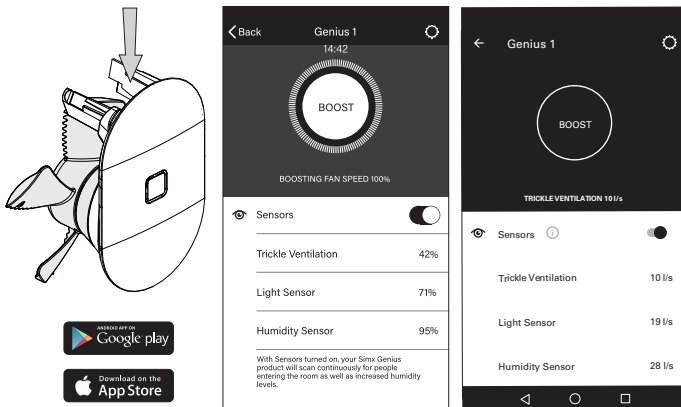

Assembly through the wall.

- A: Drill an approx. Ø5 mm governing hole straight through the wall where the fan is to be installed. Then by using the governing hole, use a Ø110 mm hole saw to drill through the wall from both sides.
- B: Seal the duct joints with moisture-proof tape or sealing compound.
- C: Place the tube parallel with the wall on the inside. Make sure to keep the outer smaller end to the grill side. Then mark the correct length on the grill side, -25 mm.
- D: Cut the duct to correct length with a saw.
- E: Seal the exterior wall grating with sealing compound.
- F: Assemble the exterior wall grating on the duct. Seal the joints with moisture-proof tape or sealing compound.
- G: Screw the exterior wall grating to the wall, let the pipe in the wall lean some degrees outward so condensed water can flow to the outside, see Figure H.
- I: Importantly, Manrose Genius is factory-programmed to work with a continuous basic flow of 30 m³ / h. If continuous basic flow is required, do not install the supplied back draught shutter. Back draught shutter shall only be used when features have been selected where the fan in normal mode is stopped. To set the fan to other functions, download of the Simx Manrose Genius app. is required. See enclosed manual 009-500002 in the fan's packaging.
- J: When the supplied back draught shutter must be used, be sure to position it as shown in Figure J, then insert the damper in the duct according to figure K.
- L: Mount the Manrose Genius fan according to the enclosed user and installation guide 009-500002.

Learn more about all the possibilities with our app at www.manrose.co.nz

