



Description	Order Code
EC Inline Duct Fan	FAN0085

This 150mm diameter inline duct axial EC fan is suitable for straight forward domestic bathroom ventilation applications.

The high speed brushless EC motor, fitted with integral ball bearings, mean a long service life and a quieter operation. These fans are generally mounted in the ceiling cavity to exhaust air from interior vents to the outside. The compact design, low profile, ease of mounting and IP rating to IP44 ensure a straight forward installation.

Suitable for extracting air from toilets and bathrooms. Ideal for the supply of fresh air to stale enclosed areas.

Thank you for purchasing this quality EC inline duct fan.

To ensure correct function and safety, please read all instructions before using the product and keep all instructions for future reference.



When using electrical appliances, basic safety precautions should always be followed to reduce the risk of fire, electrical shock and personal injury.



TECHNICAL DATA

Order Code	FAN0085
Motor	EC motor
Supply	110-240V-50Hz
Wattage	18W
Fan Performance	105 l/s, 380m ³ /hr (free air performance)
Max. Pressure	91Pa
Housing	Die cast aluminium
Impeller & Outer Rotor	PBT plastic
Max. Operating Temp	45°C
IP Rating	IP44
Compliance	AS/NZS60335-2.80:2016

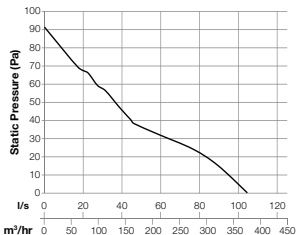

DIMENSIONS

Product	A	B	C	D
Hyper150 EC	200	143	170	185

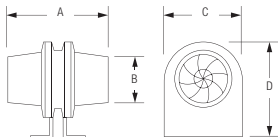



EC INLINE DUCT FAN INSTALLATION AND ELECTRICAL CONNECTION MUST
BE CARRIED OUT BY A REGISTERED ELECTRICIAN



IMPORTANT

This EC inline duct fan must be installed by a registered electrician and its installation and connection to the power supply must comply with all current Australian and New Zealand electrical and building regulations including AS/NZS3000:2017, or latest edition thereof.

The power supply cable must be suitably rated by a registered electrician to satisfy the total load on that circuit.

ELECTRICAL CONNECTIONS

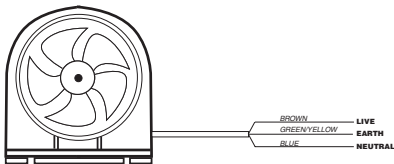

WARNING

1. This EC inline duct fan may only be used as recommended by the manufacturer in this manual. Any other use not recommended by the manufacturer may cause fire, electric shock, or injury to persons. Contact the manufacturer, or local agent, if required.
2. Isolate the mains supply before making any electrical connections. This system should be installed by a registered electrician.
3. Ensure the EC inline duct fan is properly earthed.
4. The EC inline duct fan must be able to be isolated from the power by means of a disconnect switch meeting current electrical regulations.
5. The EC inline duct fan is not intended for use by persons (including children) with reduced physical, sensory or mental capabilities, or lack of experience and knowledge, unless they have been given supervision or instruction concerning use of the appliance by a person responsible for their safety.
6. Children should be supervised to ensure that they do not play with the EC inline duct fan.

IMPORTANT CONSIDERATIONS

Planning can make a big difference to the installation time and your satisfaction with the operation of the unit.

1. Remove the unit from its packaging and check to make sure it is in good condition before using.
2. Do not let children play with packaging.
3. Check the household voltage to ensure it matches the EC inline duct fan's rated specification.
4. Check the power cord and plug carefully before using to ensure there is no damage.
5. Before unplugging the power cord, be sure to turn off the power. When energizing the unit, be sure your hands are dry to prevent electric shock.
6. This EC inline duct fan is hot when in use. To avoid burns, do not let bare skin touch hot surfaces. Keep combustible materials away from the EC inline duct fan and keep them away from the sides and rear.
7. Do not use near or in the immediate vicinity of a bath or swimming pool or any wet areas.
8. To protect against electric shock, do not immerse cord or plug in water or any other liquids.
9. Do not insert or allow foreign objects to enter any ventilation openings, as this may cause an electric shock, fire or damage to the EC inline duct fan.
10. Do not put fingers or foreign objects into the grille while in operation.
11. Any changes, or modifications, made, or attempted, to this product, without the prior written approval of the manufacturer, will void any, and all, stated warranties.
12. To prevent overheating of this appliance, keep the air inlets and outlets clean and free of anything that may cause blockage. Check all inlets and outlets from time to time to ensure it is clear of any dirt or dust accumulation. DO NOT COVER.
13. Do not use it in areas where gasoline, paint, or flammable liquids are used or stored.
14. This product contains recyclable materials. Do not dispose of this product as unsorted council waste. Please contact your local council for the nearest collection point.

BEFORE INSTALLING THE EC INLINE DUCT FAN, MAKE SURE YOU HAVE TURNED OFF THE MAIN ELECTRICITY SUPPLY. DO NOT TURN IT BACK ON UNTIL THE EC INLINE DUCT FAN IS FULLY INSTALLED AND READY TO USE.



ALL ELECTRICAL WORK MUST BE CARRIED OUT BY A REGISTERED ELECTRICIAN IN ACCORDANCE WITH THE LATEST WIRING RULES AS/NZS3000.

INSTALLATION

The plastic spigots have been designed for easy mounting onto a flat solid surface such as the top plate of a wall partition, or ceiling joist, as found in a roof cavity or, alternatively, to avoid possible resonance effects the motor can be suspended from the rafters.

TYPICAL INSTALLATION

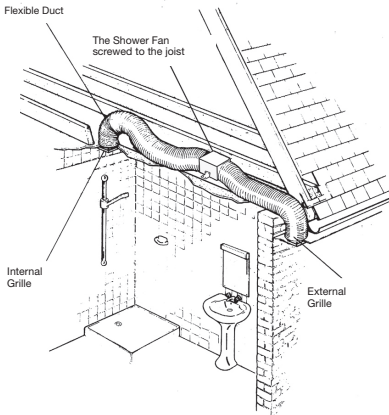

Specifications are subject to change without notice



Simx Warranty Information

In this warranty:

We means Simx;

You means the consumer of the Goods

Supplier means the authorised distributor or retailer that sold you the Goods in New Zealand or Australia; and

Goods means the Simx product accompanied by this warranty and purchased in New Zealand or Australia.

The benefits provided to you under the following warranty are in addition to any other rights and remedies available to you under the law:

1. If, during the time from the date of purchase (Warranty Period), there is a defect in the Goods due to improper workmanship or material, we will replace or repair the Goods without charge. Any replacement product is warranted only for the time remaining on the original Warranty Period.
2. We are not obliged to replace or repair the Goods under clause 1 if the Goods have been improperly stored, installed, connected, used, operated, repaired, damaged, abused, tampered with, altered (without our written approval), or not maintained in accordance with our recommended installation, connection and operating instructions.
3. We exclude liability for:
 - a) consequential loss or any other loss or damage caused to property or persons arising from any cause whatsoever;
 - b) damage to consumable items such as lamps and starters; and
 - c) damage arising from normal wear and tear.
4. In order to claim under this warranty you must, within the Warranty Period, return the Goods to the Supplier, together with the original proof of purchase including the details below:

Supplier Name _____

Date of Purchase _____

Model Number _____

Invoice/Receipt No. _____

5. This warranty does not cover the cost of claiming under the warranty or transporting the Goods to and from the Supplier.

Our Goods come with guarantees that cannot be excluded under the New Zealand and Australian Consumer Law. You are entitled to a replacement or refund for a major failure and for compensation for any other reasonably foreseeable loss or damage. You are also entitled to have the Goods repaired or replaced if the Goods fail to be of acceptable quality and the failure does not amount to a major failure.

To speak to someone about your Simx product or claiming under this warranty, please contact:

Simx Ltd New Zealand

p: +64 9 259 1660 f: +64 9 259 1661

www.simx.co.nz

WESTAFLEX

HVAC Distributor within Australia

p: 03 9458 2122 e: sales@westaflex.com.au

www.westaflex.com.au