



Description	Switching	Product Code
Inline Axial Fan	Standard Timer	FAN0090 FAN0091

This Manrose inline extraction fan kit is designed for ventilation within a shower cubicle.

Thank you for purchasing this quality 150mm inline extraction fan.
To ensure correct function and safety, please read all instructions before using the product and keep all instructions for future reference.



When using electrical appliances, basic safety precautions should always be followed to reduce the risk of fire, electrical shock and personal injury.



SPECIFICATIONS

Duct (mm)	Fan Type	Max. Fan Watts (W)	Max. Fan Pressure (PA)	Free Air Fan Performance		Specific Fan Power (W/l/s)
				(l/s)	(m ³ /hr)	
150	Axial	25	60	87	313	0.29



E6337 Compliance: AS/NZS60335-2.80:2016

DIMENSIONS

A	B	C	D	E
187	153	109	150	27

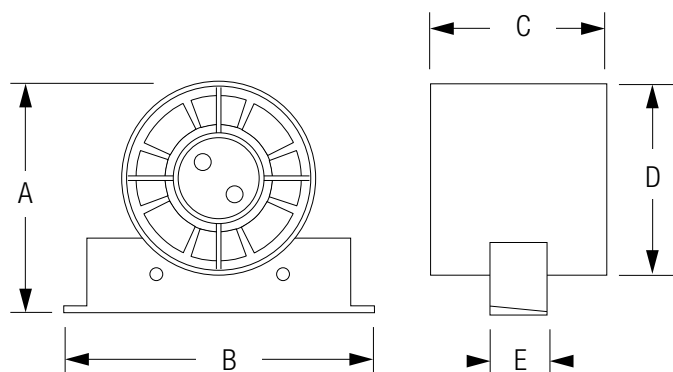

TECHNICAL

Supply	Sound Level	Max. Operating Temp	IP Rating
220-240V AC, 50Hz	40 dB(A)	40°C	IP44

REGULATIONS AND STANDARDS

New Zealand Building Code and Healthy Homes

The following two category requirements have been established for mandatory extraction ventilation in New Zealand.

The New Zealand Building Code for New Building Consents

The building regulatory system sets out a framework to promote good quality decisions being made during the Building Consent process. The legislation and regulations work together, as the building regulatory system. The functional clauses of the NZ Building Code are grouped and described by a letter and number. Clause G of the NZ Building Code covers services, with G4 setting out the performance requirements for ventilation. The Building Code is enshrined in law. The New Zealand Building Code, G4, has been changed. This is supported by Acceptable Solution G4/AS1 Fourth Edition that specifies mechanical ventilation in accommodation units that contain cooktops, showers and baths.

Residential Tenancy Regulations to the Healthy Homes Standards

Residential Tenancy Regulations for rental properties only is changing to the Healthy Homes Standards, sub part 4 - Ventilation Standards.

Complying with the Acceptable Solution G4/AS1

To comply, the mandatory mechanical extract system must deliver minimum airflow rates for the complete installed ventilation system. This means that airflow rates must deliver the airflow after resistance of the ducting, internal and external grilles, as well as all other accessories, such as backdraught shutters, are included.

Fan selection is important as some types are far better at overcoming ducting system pressure drops.

Additionally, the quality of the ducting system installation can be all important. Rigid duct systems (see page 102) are best as they are the most efficient. Good installation practice is vital for flexible duct systems.

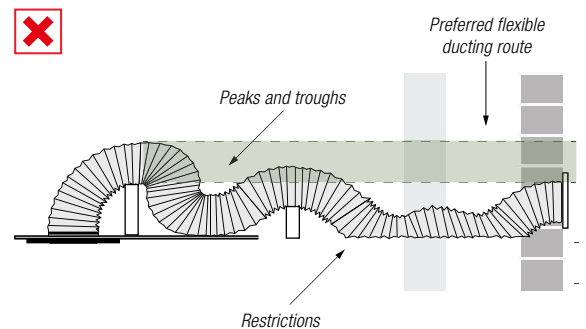
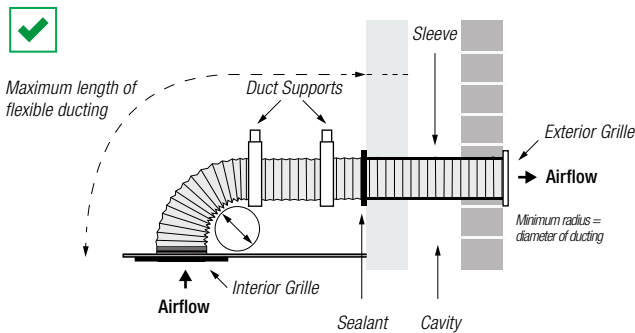

Choosing the Right Fan to Comply

Fans cannot be selected on the basis of free-air performance only. Fans must now be selected on the basis of the complete installed system performance for a designated room as per the table below.

Room	Airflow Rate (min.)	
	Intermittent	Continuous
Toilet ¹⁾	25 l/s	10 l/s
Bathroom/shower	25 l/s	10 l/s
Laundry ²⁾	40 l/s	-
Kitchen	50 l/s	12 l/s

1) Toilets only require ventilation if they have no openable windows

2) Simx recommends 40 l/s for laundries with unvented non-condensing tumble dryers as covered in AS 1668: Part 2 2012

Recent unregulated extract fan practices in New Zealand has trended to basic, low pressure axial fan products, as installed system performance has not been defined for independent inspection testing and compliance signed off by local authorities.

Bathroom

25 l/s

		Metres of Ducting									
		1	2	3	4	5	6	7	8	9	10
No. of Bends	1	Hyper150 EC	Hyper150 EC	Hyper150 EC	Hyper150 EC	Hyper150 EC	Hyper150 EC	Hyper150 EC	Hyper150 EC	Hyper150 EC	Hyper150 EC
	2	Hyper150 EC	Hyper150 EC	Hyper150 EC	Hyper150 EC	Hyper150 EC	Hyper150 EC	Hyper150 EC	Hyper150 EC	Hyper150 EC	Hyper150 EC
	3	Hyper150 EC	Hyper150 EC	Hyper150 EC	Hyper150 EC	Hyper150 EC	Hyper150 EC	Hyper150 EC	Hyper150 EC	Hyper150 EC	Hyper150 EC
	4	Hyper150 EC	Hyper150 EC	Hyper150 EC	Hyper150 EC	Hyper150 EC	Hyper150 EC	Hyper150 EC	Hyper150 EC	Hyper150 EC	Hyper150 EC
	5	Hyper150 EC	Hyper150 EC	Hyper150 EC	Hyper150 EC	Hyper150 EC	Hyper150 EC	Hyper150 EC	Hyper150 EC	Hyper150 EC	Hyper150 EC

Fan Selection

Hyper150 EC

Mixflo 150

Kitchen

50 l/s

		Metres of Ducting									
		1	2	3	4	5	6	7	8	9	10
No. of Bends	1	Hyper150 EC	Hyper150 EC	Hyper150 EC	Hyper150 EC	Hyper150 EC	Hyper150 EC	Hyper150 EC	Hyper150 EC	Hyper150 EC	Hyper150 EC
	2	Hyper150 EC	Hyper150 EC	Hyper150 EC	Hyper150 EC	Hyper150 EC	Hyper150 EC	Hyper150 EC	Hyper150 EC	Hyper150 EC	Hyper150 EC
	3	Hyper150 EC	Hyper150 EC	Hyper150 EC	Hyper150 EC	Hyper150 EC	Hyper150 EC	Hyper150 EC	Hyper150 EC	Hyper150 EC	Hyper150 EC
	4	Hyper150 EC	Hyper150 EC	Hyper150 EC	Hyper150 EC	Hyper150 EC	Hyper150 EC	Hyper150 EC	Hyper150 EC	Blue Jet	Blue Jet
	5	Hyper150 EC	Hyper150 EC	Hyper150 EC	Hyper150 EC	Hyper150 EC	Hyper150 EC	Hyper150 EC	Hyper150 EC	Blue Jet	Blue Jet

Blue Jet



INLINE EXTRACTION FAN KIT INSTALLATION AND ELECTRICAL CONNECTION MUST BE CARRIED OUT BY A REGISTERED ELECTRICIAN



CAUTION

- Before use, please check that the supply voltage and that of the appliance are the same (see product rating label).
- All wiring and wiring connections must comply with all current national wiring rules and regulations including AS/NZS3000:2017, or latest edition thereof.
- Any changes or modifications made or attempted to this product, without the prior written approval of the manufacturer, will void any and all stated warranties.
- When fitting through an external wall, an external grille must be fitted at all times.
- Fan kits should only be installed by fixed wiring. A flexible cord should not be used.
- This fan is not intended for use by persons (including children) with reduced physical, sensory or mental capabilities, or lack of experience and knowledge, unless they are capable of, and have been given supervision or instruction concerning use of the appliance by a person responsible for their safety.
- Children should be supervised to ensure that they do not play with the fan.
- In case of damage to the supply cord, switch off the device and do not tamper with it. Damaged supply cords must only be repaired or replaced exclusively by the manufacturer or by an appointed representative. Failure to comply with the above may endanger the safety of people and cause possible damage to the whole system.
- The fan kit is to be installed so that the blades are more than 2.1m above the floor.
- Exhaust fans may adversely affect the safe operation of appliances burning gas or other fuels (including those in other rooms) due to back flow of combustion gases. These gases can potentially result in carbon monoxide poisoning. After installation of an exhaust fan such as a partition fan or a duct fan the operation of flued gas appliances should be tested by a competent person to ensure that back flow of combustion gases does not occur.



BEFORE INSTALLING THE INLINE EXTRACTION FAN KIT, MAKE SURE YOU HAVE TURNED OFF THE MAIN ELECTRICITY SUPPLY. DO NOT TURN IT BACK ON UNTIL THE INLINE EXTRACTION FAN KIT IS FULLY INSTALLED AND READY TO USE.



ALL ELECTRICAL WORK MUST BE CARRIED OUT BY A REGISTERED ELECTRICIAN IN ACCORDANCE WITH THE LATEST WIRING RULES AS/NZS3000.

WARNING

- This inline extraction fan is hot when in use. To avoid burns, do not let bare skin touch hot surfaces. Keep combustible materials away from the fan kit and keep them away from the sides and rear.
- Do not use near or in the immediate vicinity of a bath or swimming pool or any wet areas.
- To protect against electric shock, do not immerse cord or plug in water or any other liquids.
- Do not insert or allow foreign objects to enter any ventilation openings, as this may cause an electric shock, fire or damage to the fan kit.
- Do not put fingers or foreign objects into the grille while in operation.
- Any changes or modifications made or attempted to this product, without the prior written approval of the manufacturer, will void any and all stated warranties.
- To prevent overheating of this fan kit, keep the air inlets and outlets clean and free of anything that may cause blockage. Check all inlets and outlets from time to time to ensure it is clear of any dirt or dust accumulation. **DO NOT COVER.**
- Do not use it in areas where gasoline, paint, or flammable liquids are used or stored.
- This product contains recyclable materials. Do not dispose of this product as unsorted council waste. Please contact your local council for the nearest collection point.

Fig 1

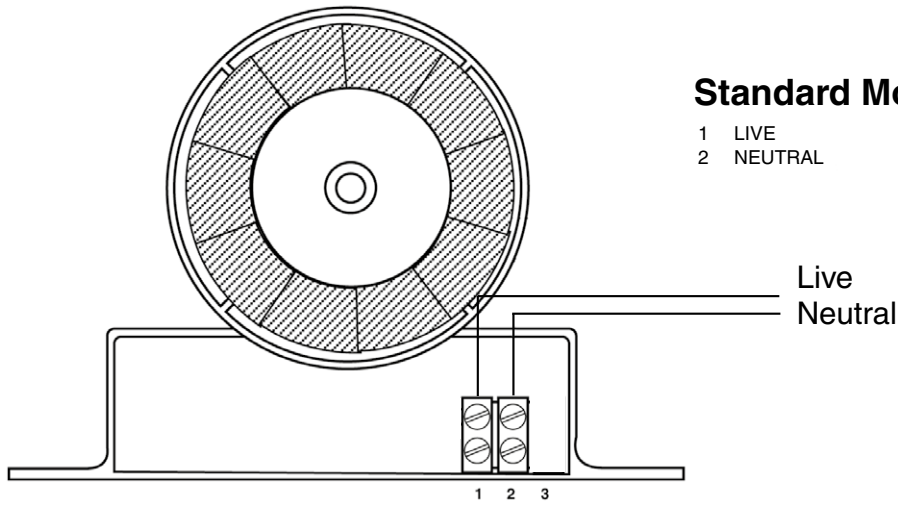
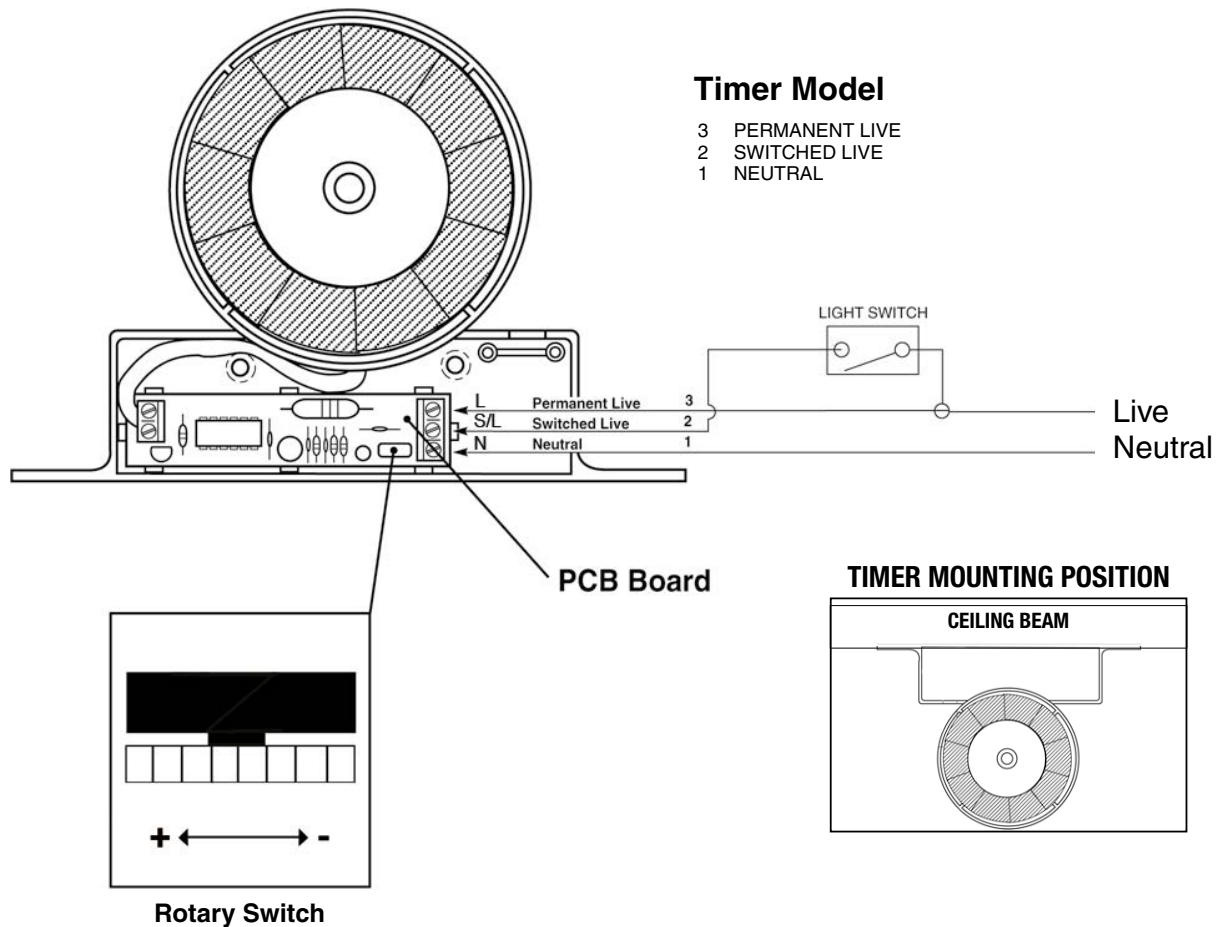

Fig 2



INSTALLATION

1. Cut a suitable size hole for the grille in the ceiling directly over the shower head ensuring first that the area above is free from obstruction and between two joists.
2. Select a suitable place for the fan to be screwed to a joist and secure using two screws through the fixing bracket.
3. Select a suitable position either in the soffit or on an outside wall and cut a suitable size hole for the eggcrate grille. Attach one end of the flexible duct to grille with duct tape and from the outside feed the ducting through the hole until the grille is flush with the soffit/wall. Secure the grille to the wall.

NOTE: It is best not to cut the flexible ducting until the grille has been screwed to the outside surface to avoid the possibility of cutting the duct too short.

4. Pull the flexible ducting gently to the discharge spigot of the fan and cut it to length and connect to the fan with duct tape.

NOTE: The discharge end of the fan unit is the end where you can see the fan blade clearly. There is also an arrow on the unit showing airflow direction.

5. Connect the other piece of duct to the ceiling grille and onto the fan as before using duct tape.

NOTE: Make sure wherever possible to keep the duct running in a straight line as this will improve the performance of the fan.

6. Make the electrical connection as follows:

Wiring of Standard Switching model FAN0090 (fig.1).

The fan can be connected to the light switch so that the fan will start when the light is switched on, or a dedicated fan switch (not supplied). The fan should not be accessible to a person using either the shower or the bath.

Wiring of Timer Switching model FAN0091 (fig. 2).

The fan can be connected to the light switch so that the fan will start when the light is switched on, or a dedicated fan switch (not supplied). The fan should not be accessible to a person using either the shower or the bath.

NOTE: All wiring must be fixed securely and the cable to the fan should be a minimum of 1mm² in section in section. All wiring must comply with current regulations. This system should be installed by a registered electrician.

When the light switch or fan switch is switched off the fan will run for between 20 seconds & 30 minutes (pre-set to 1 minute). This can be adjusted in Timer Adjustment instructions on page 6. The fan should not be accessible to a person using either the shower or the bath.

NOTE: This unit is double insulated and therefore does not require an earth. Try to keep the duct as straight as possible and wherever possible keep the distance between the ceiling grille and the external soffit or wall as short as possible as the shorter the length of duct, the better the performance of the fan.

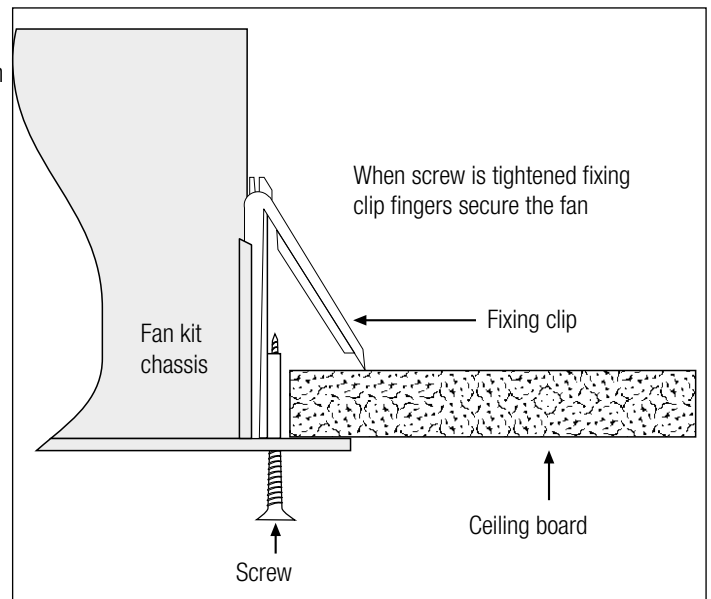

MANROSE[®]

Warranty Information

In this warranty:

We means Manrose;

You means the consumer of the Goods

Supplier means the authorised distributor or retailer that sold you the Goods in New Zealand or Australia; and

Goods means the Manrose product accompanied by this warranty and purchased in New Zealand or Australia.

The benefits provided to you under the following warranty are in addition to any other rights and remedies available to you under the law:

1. If, during the time from the date of purchase (Warranty Period), there is a defect in the Goods due to improper workmanship or material, we will replace or repair the Goods without charge. Any replacement product is warranted only for the time remaining on the original Warranty Period.
2. We are not obliged to replace or repair the Goods under clause 1 if the Goods have been improperly stored, installed, connected, used, operated, repaired, damaged, abused, tampered with, altered (without our written approval), or not maintained in accordance with our recommended installation, connection and operating instructions.
3. The warranty provided under clause 1 is limited to replacement or repair of the Goods only, at our option. To the extent permitted by law, we exclude liability for:
 - a) consequential loss or any other loss or damage caused to property or persons arising from any cause whatsoever;
 - b) damage to consumable items such as lamps and starters; and
 - c) damage arising from normal wear and tear.
4. In order to claim under this warranty you must, within the Warranty Period, return the Goods to the Supplier, together with the original proof of purchase including the details below:

Supplier Name _____

Date Of Purchase _____

Model Number _____

Invoice/Receipt No. _____

5. This warranty does not cover the cost of claiming under the warranty or transporting the Goods to and from the Supplier.

Our Goods come with guarantees that cannot be excluded under the Australian Consumer Law. You are entitled to a replacement or refund for a major failure and for compensation for any other reasonably foreseeable loss or damage. You are also entitled to have the Goods repaired or replaced if the Goods fail to be of acceptable quality and the failure does not amount to a major failure.

To speak to someone about your Manrose product or claiming under this warranty, please contact:

Simx Ltd New Zealand

p: +64 9 259 1660

f: +64 9 259 1661

www.simx.co.nz