

EASYFIT GRILLE - 150mm Circular Ceiling Grille

DCT1550 - White

DCT1553 - Black

Installation

Position the unit, taking into consideration the position of the rooms to be ventilated. To reduce the system resistance in your duct system, and therefore lower the speed, power consumption and noise of the fan, follow these guidelines:

- Keep the length of duct runs to a minimum, particularly the exhaust duct run.
- When using the flexible ducting in the kit, make sure that it is fully extended and not crushed, sagging or torn.
- Try to minimize the use of diffusers/valves by having similar length duct runs to the inlets.
- The bend radius (measured to the inside of the bend), should be at least 1x the duct diameter.
- Avoid having any bends, filters or other obstructions within 250mm of the fan inlets and outlet.

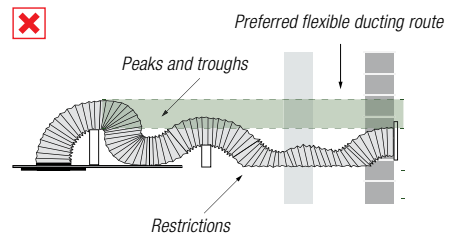
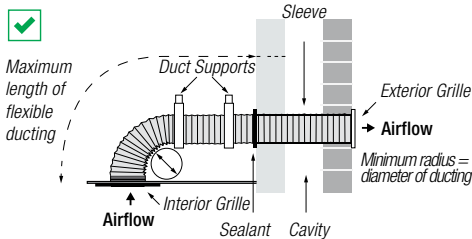

- Cut a hole size 195mm (tolerance is +/- 5mm) in the required location
- Use wings for 10mm thick ceilings
- Wing mounting: Fold wings in to fit into hole, push base into the hole.



Installation

- Wing dismantling: While applying a gentle force to extract the base rotate the base Clock-wise.
- Use clamps for 13mm to 26mm thick ceilings
- Clamp mounting: Undo 3 screws until the clamp is a couple of millimeters thicker than your ceiling, fold the clamps and wings in to fit into hole, push base into the hole and tighten the 3 screws until there is a slightly tighter resistance. Check the slotted holes next to each screw to ensure the clamps have been deployed.
- Clamp dismantling: Undo all 3 screws and fold them in, while applying a gentle force to extract the base rotate the base Clock-wise.

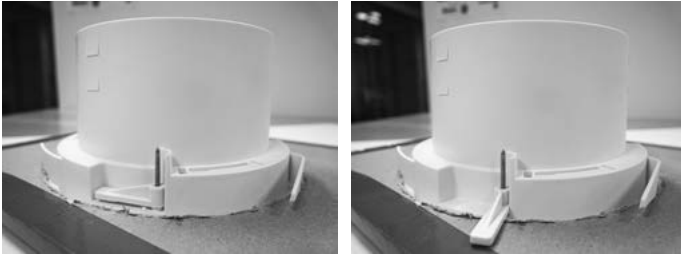

- Fascia mounting: Align the 3 clips on the fascia with the 3 slots on the base and push in until you hear a click. If no click is heard, back the fascia out and rotate it Clock-wise slightly and push it back in to hear the click.
- Fascia removal: Rotate the fascia Counter-clock-wise.
- Use the mounting clamps for a more secure grille to ceiling fit.

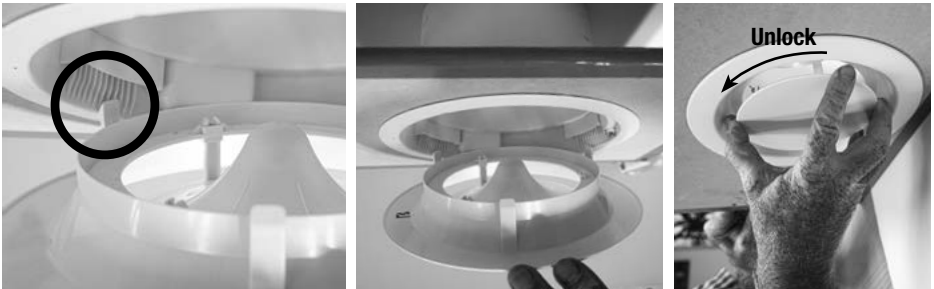

Installation

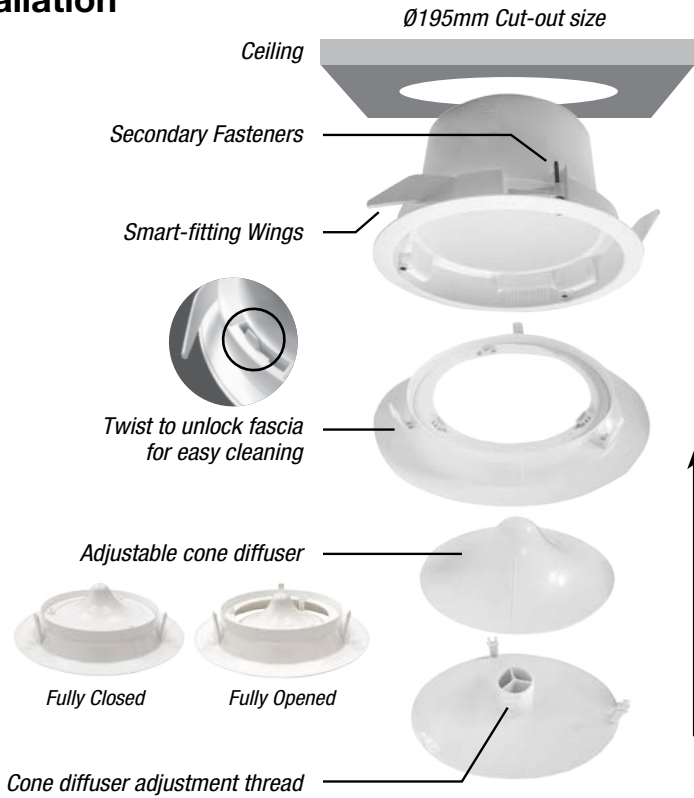

Normally, this is not required, however if the fascia needs to be removed separately, follow the process below.

